



The Principles of Green Building Design

3 units INTD 62-6512

Meets Wednesday evening 6-9 pm , Feb 4 - June 3, 2008

- Ø Design using Passive Techniques
- Ø Integrate Green Technology Components
- Ø Minimize Impacts of Designs on the Natural Environment

Weekly Outline

Feb 4	Introduction to Course Outline and Workshop Objectives Course Intro Presentation, Student Needs Assessment, Competition Brief
Feb 11	Sustainable Design Tools - Visualization Sketch Up, Basic Rendering, Layout, Scale Model Building
Feb 18	History of Green Building Design and Masterplanning
Feb 25	Green Building Design Lectures 2-3 Site Assessment and Building Topologies
Mar 4	Building with the Sun - Niklas Spitz - Ecologic Design Lab Green Building Design Lectures 4-5
Mar 11	Building with Water - Brent Bucknum - Hyphae Design Laboratory Building with Soil - Marisha Farnsworth - The Natural Builders Green Building Design Lectures 6-7
Mar 18	Building with Vegetation - Green Roof Design - Cooper Scollan Building with Air Green Building Design Lectures 8
Mar 25	Green Building Material Specification - with Libby Barnes Green Building Design Lectures 9-10
Apr 1	Building Energy Analysis Monitoring with Brent Bucknum Green Building Design Lectures 11-12 Smart Growth
Apr 15	Building Life Cycle Analysis and Metabolism Green Building Design Lectures 13
Apr 22	Green Building Rating Systems Radical Remodel Internal Review
Apr 29	Radical Remodel Mid-Review with Invited Guests
May 6	Case Study Design Analysis
May 13	Field Trip
May 20	Final Review with Invited Guests

Launch a green building career!

This course is a series of lectures, case studies and design workshop projects which explore critical concepts of the current state of green building design. The specific design themes and case studies will be actualized in the students' own design work. Appropriate for beginning and advanced designers as well as homeowners and developers.

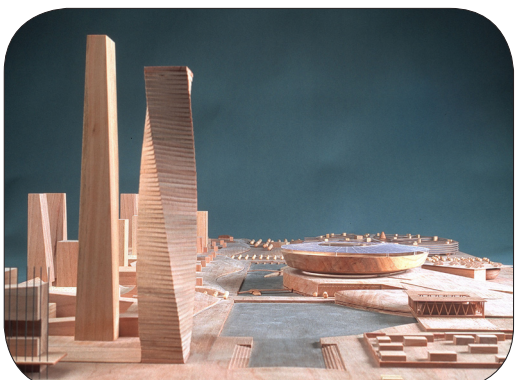
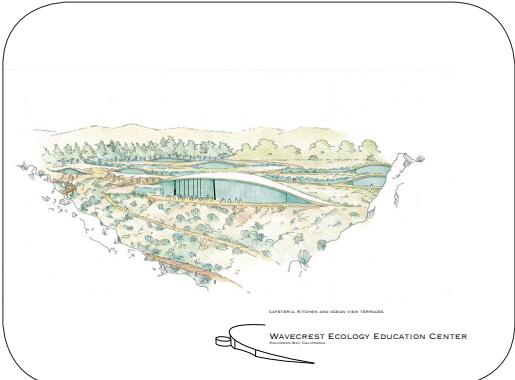
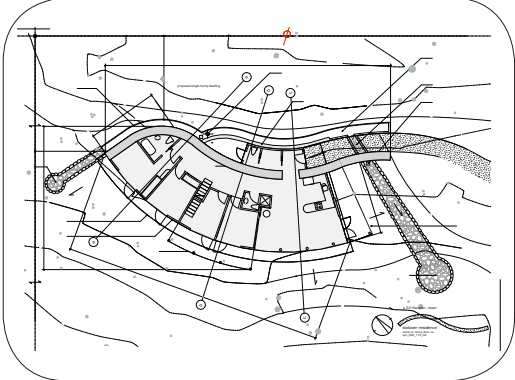

sample techniques

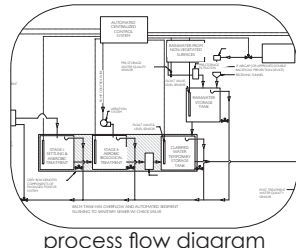

process flow diagram

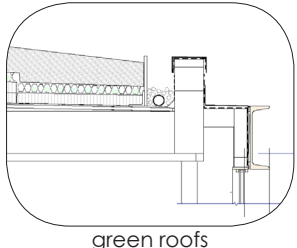

green roofs

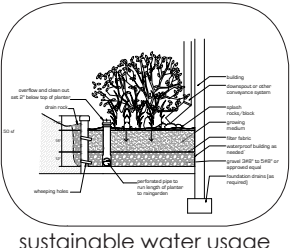

sustainable water usage

Thomas Rettenwender
MA, Mag Arch, Architect

Niklas Spitz
Executive Director

www.ecologicdesignlab.com

- with
- Libby Barnes, Architect - Carver & Schickentanz
 - Brent Bucknum - Hyphae Design Laboratory
 - Daniel 'Fletch' Fleischer - Aurora Biofuels
 - Marisha Farnsworth - The Natural Builders
 - Dirk Junklewitz - Treusch Architecture
 - Sharon Lynn Lloyd - Green Building Design Forum
 - Cooper Scollan - Habitat Gardens
 - Christopher Williams - Archetype
 - April Allard - Native Plant Society
 - Ken Principe - Landscape Architect

Starts - Feb 4, 2008 6pm

enroll now at www.mpc.edu

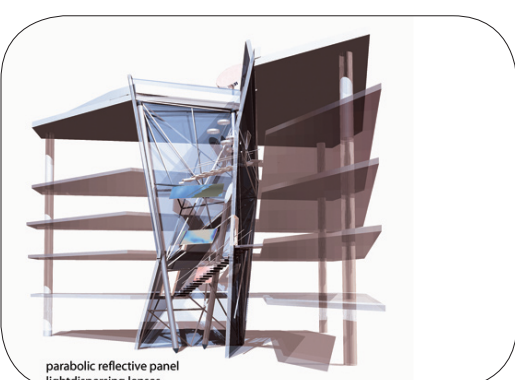
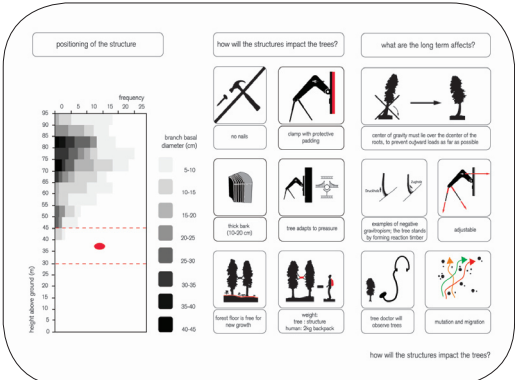

parabolic reflective panel
light-dispersing lenses